

Profilés ALU

Sections têtes des gâches

P 24 x 3 mm

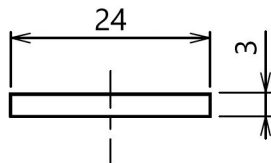

U 24 x 6 mm

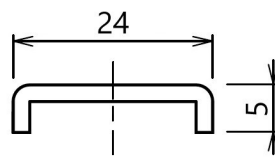

Sections têtes des gâches équipées de clames

U 24 x 5 mm
"Type CV1"

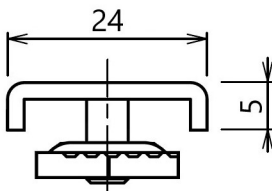

P 24 x 3 mm
"Type CV1"

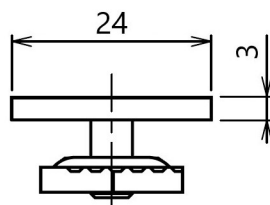

cale 26 x 4.5 mm
"Type CCV1"

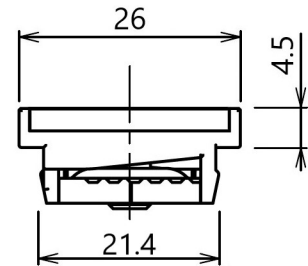

cale 38 x 4.5 mm
"Type CCV2"

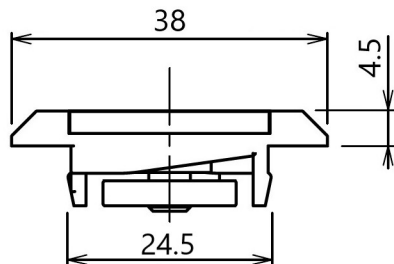

cale 34.6 x 6.3 mm
"Type CCV3"

