

**Kits poignée**

**Supports droits**

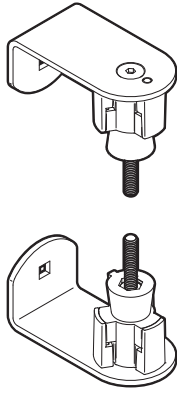

**Ou**

**Supports inclinés**

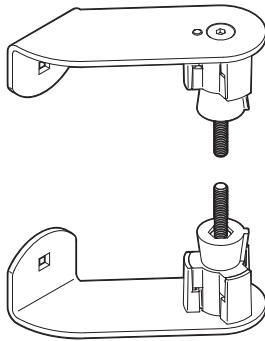

**Barreau**

Aluminium

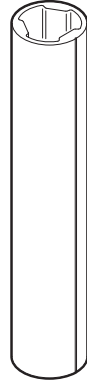

Inox



**1** Recouper le barreau (bien ébavurer les bords)

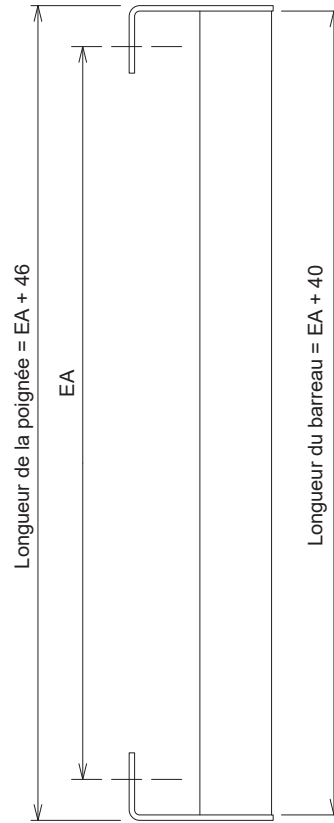

**2** Les supports sont livrés pour un barreau Ø40mm, pour un barreau Ø35mm, suivre la procédure suivante :

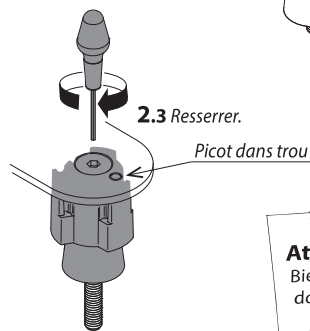
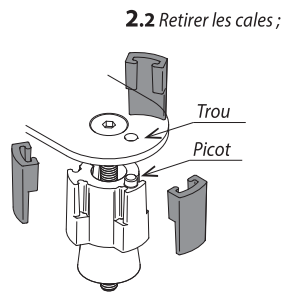
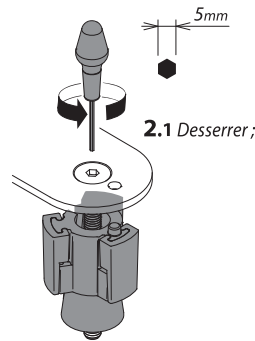

**Attention** !  
Bien placer le picot dans le trou !

**3** Positionner les supports sur le barreau ;



**4** Serrer les vis de blocage.

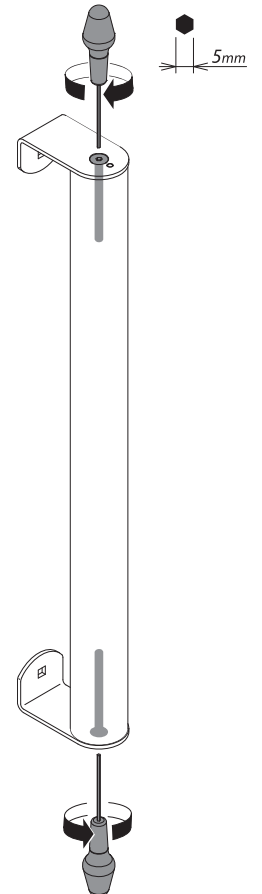

### Fixation non traversante pour 1 poignée

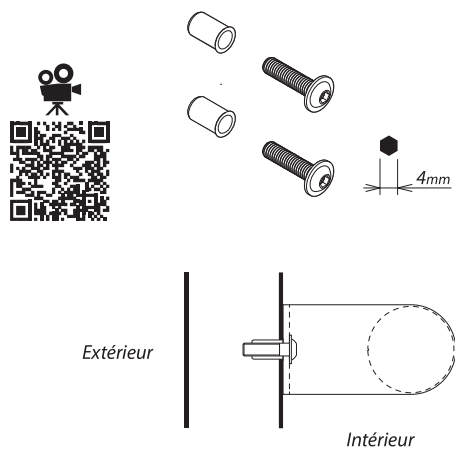

#### 1 Percer le profil ;

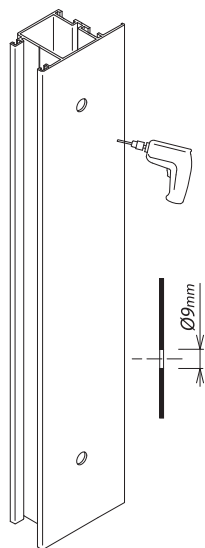

#### 2 Placer puis serrer les écrous ;

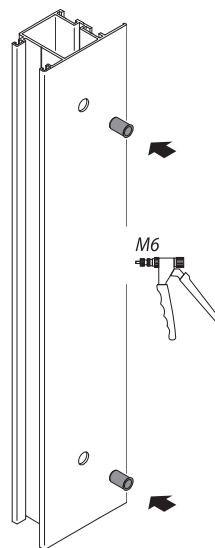

#### 3 Fixer la poignée sur le profil.

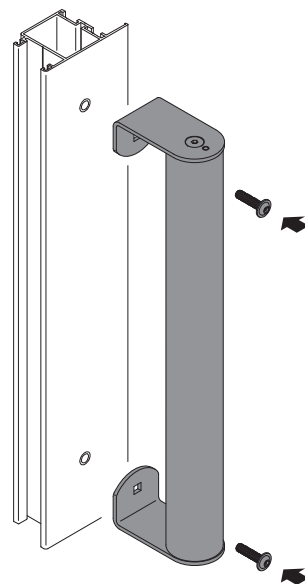

### Fixation traversante pour 1 poignée

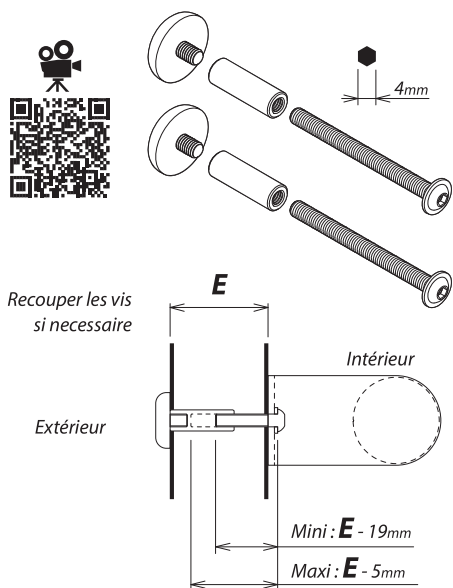

#### 1 Percer le profil ;

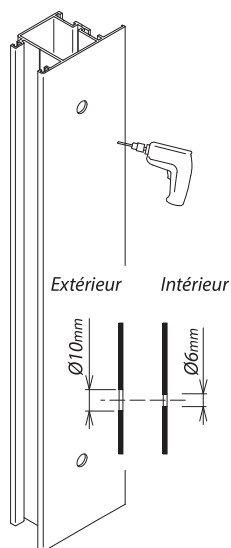

#### 2 Fixer la poignée sur le profil.

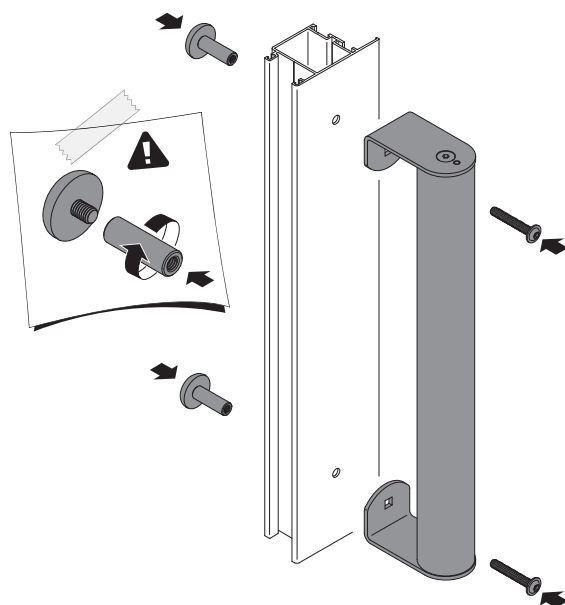

### Fixation traversante pour 2 poignées

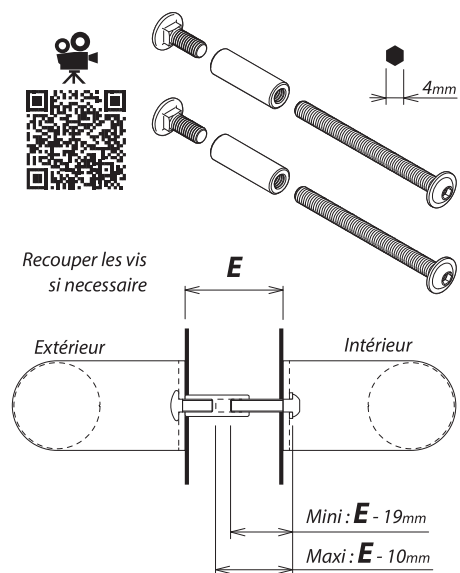

#### 1 Percer le profil ;

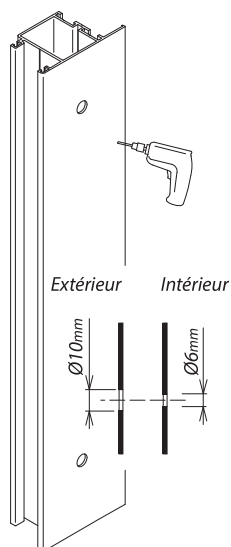

#### 2 Placer les vis (avec embase carrée) et les fûts sur la poignée extérieure ;

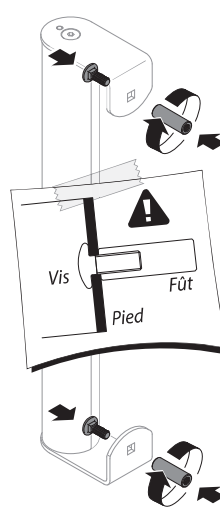

#### 3 Fixer les poignées sur le profil.

